

(*) Correct the gasket form by the help of hot water and hair dryer.

Changing The Door Swing Direction to Right Hand

1- Unscrew the two screws fixing the top hinge (Pic-1) and remove the refrigerator door. (Pic-2)



Picture-1



Picture-2

2- Unscrew the two screws fixing the middle hinge side bracket and remove it. (Pic-3)



Picture-3

3- Unscrew the two screws fixing the middle hinge (Pic-4) and remove the freezer door. (Pic-5)



Picture-4



Picture-5

4- Remove the bottom hinge pin (Pic-5) and insert it to the left side foot. (Pic-6)



Picture-5



Picture-6

5- Unscrew the middle hinge side bracketed on the left and remove it. (Pic-7)
Remove the middle hinge screw caps (big) on the left side.



Picture-7

6- Assemble the refrigerator door. Rotate the middle hinge by 180° and screw it to the left side. (Pic-8) Then screw the middle hinge side bracketed on the middle hinge. (Pic-9)



Picture-8



Picture-9

7- Remove the top hinge screw caps (big) on the left side (Pic-10) and insert them to the right side. (Pic-11) (You can find the new caps in the user manual bag)



Picture-10



Picture-11

8- Unscrew the pin of the hinge from Hole 1, rotate the top hinge by 180° and screw the pin to Hole 2. (Pic-12)

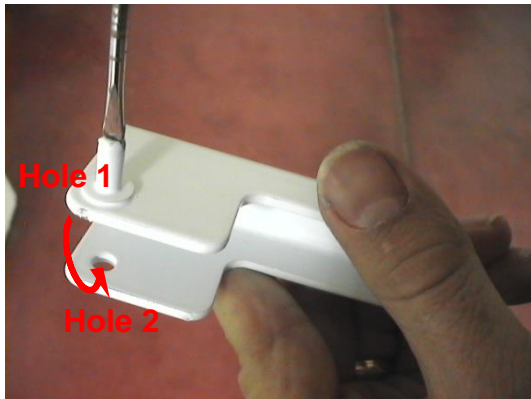

Picture-12

9- Assemble the freezer door and screw the top hinge to the left side. (Pic-13)



Picture-13

10- Screw the middle hinge side bracketed on the right of refrigerator. (Pic-14) and insert the middle hinge screw caps (big) on the right side. (Pic-15) (You can find the new caps in the user manual bag)



Picture-14



Picture-15

Replacement of Door Switch

1. Insert a screwdriver into the gap and pull the door switch.



Picture-1

2. Disconnect the connectors. And remove the door switch.



Picture-2