

Instructions for use  
**Upright freezer**

**ATAG**

KA2512C

---

We thank you for the confidence you have shown by purchasing our appliance which is designed to simplify your life. To make the use of the product easier, we have supplied detailed instructions for use, and installation instructions supplied on a separate sheet. The instructions should allow you to learn about your new appliance as quickly as possible.

We wish you find a lot of pleasure in its use.

**The appliance is intended solely for household use.**

**The freezer** is intended for freezing fresh food and for long-term storage of frozen food (up to one year, depending on the type of food).

Please visit our website where you can enter your appliance model number, indicated on the rating plate or the warranty sheet, to find detailed description of your appliance, tips on use, troubleshooting, service information, instructions for use etc.

---

# TABLE OF CONTENTS

---

## ***Introduction***

---

Safety instructions	4
Advice for saving energy with refrigeration appliances	10
Installation and connection	11
Changing the door opening direction	16

## ***Appliance description***

---

Appliance description	18
Operating the appliance	19
Appliance interior equipment	22

## ***Storing and freezing food***

---

Freezing fresh food and storing frozen food	23
---	----

## ***Defrosting and cleaning the appliance***

---

Defrosting the appliance	26
Cleaning the appliance	27

## ***Other***

---

Troubleshooting	28
Information about appliance noise	29

### Safety instructions



#### **Before using the appliance for the first time**

Before connecting the appliance to the power mains, please read carefully the instructions for use which describe the appliance and its correct and safe use. The instructions apply to several appliance types/models; thus, settings or equipment may be described herein which is not available in your appliance. We recommend saving this instruction manual for future reference and attach it to the appliance if it is sold in the future.

The instruction manual includes the NO FROST version/model of the freezer which is fitted with a fan and in which the defrosting process is automatic (only with some models).

Check for any damage or irregularities on your appliance. If you find your appliance is damaged, notify the retailer from which you have purchased the appliance.

Before connecting the appliance to the power mains, let the appliance rest in a vertical position for a minimum of 2 hours. This will reduce the possibility of operation faults due to the effect of transport on the cooling system.



### **Safety instructions**

The appliance must be connected to the power mains and grounded in compliance with the effective standards and regulations.

Before cleaning the appliance, unplug it from the power mains (unplug the power cord from the wall outlet).

If the power cord is damaged, it must be replaced by a service technician or other adequately trained person.

If LED lighting does not work, call a service technician. Do not attempt a repair of the LED lighting yourself, as there is danger of contact with high voltage!



**WARNING!** Do not use any electric devices inside the appliance, except for those allowed by the manufacturer of this refrigeration appliance.

**WARNING!** Do not use mechanical devices or other means to accelerate the defrosting process, other than those recommended by the manufacturer.

**WARNING!** To avoid any hazard resulting from poor stability of the appliance, make sure it is installed as instructed.

### **Danger of frostbite**

Never put frozen food in your mouth and avoid touching frozen food as this may cause frostnip or frostbite.

### **Safety of children and vulnerable persons**

This appliance can be used by children aged from 8 years and above and persons with reduced physical, sensory or mental capabilities or lack of experience and knowledge if they have been given supervision or instruction concerning use of the appliance in a safe way and understand the hazards involved.

Remove the packaging intended to protect the appliance or particular parts during transport and keep it outside the reach of children. It presents danger of injury or suffocation.

Store all the parts that remain out of children's reach after finishing the assembly of the appliance or after fitting it into a cabinet, as they can cause choking.

Do not let the children play with the appliance.

Cleaning and user maintenance shall not be made by children without supervision.

When removing a used appliance, disconnect the power cord, remove the door, and leave the shelves in the appliance. This will prevent children from locking themselves in the appliance.

### **Warning regarding the refrigerant**

The appliance contains a small amount of an environmentally friendly yet flammable gas R600a. Make sure that no parts of the cooling system are damaged. A gas leak is not hazardous to the environment, but it could cause eye injury or fire.

In case of a gas leak, ventilate the room thoroughly, disconnect the appliance from the power mains, and call a service technician.

### Important information on the use of appliance



**WARNING!** Keep ventilation openings, in the appliance enclosure or in the built-in structure, clear of obstruction.

The appliance may not be used outdoors and it may not be exposed to rain.

Do not store explosive substances such as aerosol cans with a flammable propellant in this appliance.

If the appliance will be out of use for an extended period of time, switch it off using the relevant button, and unplug it from the power mains. Empty the appliance, defrost it, clean it, and leave the door ajar.

In case of an error or power supply failure, do not open the freezer compartment unless the freezer has not operated for over 16 hours. After this period, use the frozen food or provide sufficient cooling (e.g. a replacement appliance).

### Technical information on the appliance

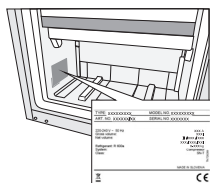

The rating plate can be found in the appliance interior (see figure). It indicates data on voltage, gross and net volume, type and amount of refrigerant, and the climate classes.



### Environment protection

The packaging is made of environmentally friendly materials that can be recycled, disposed of, or destroyed without any hazard to the environment.



#### Removing an obsolete appliance

To protect the environment, take the obsolete appliance to an authorized home appliance collection centre.

Before doing so, do the following:

- disconnect the appliance from the power mains;
- do not allow children to play with the appliance.



**WARNING!** Do not damage the refrigerant circuit. This will also prevent pollution.



The symbol on the product or its packaging indicates that the product should not be treated as normal household waste. The product should be taken to an authorized collection centre for waste electric and electronic equipment processing. Correct disposal of the product will help prevent any negative effects on the environment and health of people which could occur in case of incorrect product removal. For detailed information on removal and processing of the product, please contact the relevant municipal body in charge of waste management, your waste disposal service, or the store where you bought the product.

### ***Advice for saving energy with refrigeration appliances***

- Install the appliance as specified in the instruction manual.
- Do not open the door more often than necessary.
- Occasionally make sure air circulation underneath the appliance is unobstructed.
- Condenser unit on the rear wall should be kept clean (see chapter 'Cleaning the appliance').
- If the gasket is damaged or does not provide a perfect seal for any reason, have it replaced as soon as possible.
- Store the food in tightly sealed containers or appropriate packaging.
- To make use of the entire freezer compartment interior volume, remove some of the drawers as described in the instruction manual.
- Do not block the fan slots or vents.
- The lower the temperature is set the higher the energy consumption will be.

## *Installation and connection*

### **Selecting the room**

- Install the appliance in a dry and well ventilated room. The appliance will operate correctly if the environment temperature is in the interval specified in the table. The appliance class is indicated on the rating plate / label with the basic information of the appliance.

Class	Temperature	Relative Humidity
SN (subnormal)	from +10°C to +32°C	≤75%
N (normal)	from +16°C to +32°C	
ST (subtropical)	from +16°C to +38°C	
T (tropical)	from +16°C to +43°C	



Do not place an appliance in a room where temperature can drop to below 5°C as this may cause abnormal appliance operation or failure!

**Note:** Place the appliance in a sufficiently large room. There should be at least 1 m<sup>3</sup> of space per 8 grams of refrigerant. Amount of refrigerant is indicated on the rating plate in the appliance interior.

- At the base of the kitchen unit intended for building in the integrated appliance, there should be at least 200 cm<sup>2</sup> free space, for adequate air circulation.

On the upper part of the appliance the air is coming out, so try not to cover the opening for the outflow air. Ignoring this caution may result in damage to the appliance.

# INTRODUCTION

## Installing the appliance

Appliance installation should be carried out by at least two persons to avoid any physical injury or damage to the appliance.

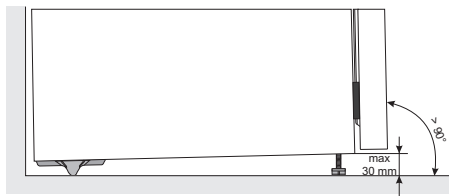

- Spacers are fitted on the corners of the doors. Remove them.
- The appliance must stand level or tilted slightly to the back, stable on a solid base. At the front, the appliance is fitted with two adjustable legs that can be used to level the appliance. At the rear side, casters allow for easier installation of the appliance (only with some models).
- There should be a clearance of at least 5 cm between the appliance and any cupboard installed above it, in order to allow adequate cooling of the condenser unit.
- The appliance is supplied with two spacers which should be installed on the lower part of the housing to prevent from pushing the appliance too close to the wall. Appliance may also be installed without the spacers; however, this may increase power consumption.
- Do not expose the appliance to direct sunlight and do not place it near any source of heat. If this cannot be avoided, install an insulation panel.

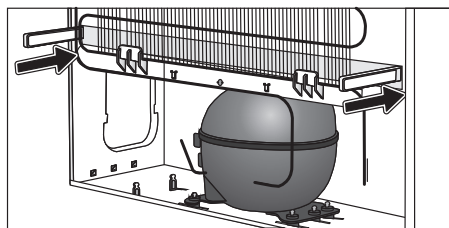

## INTRODUCTION

- The appliance may stand alone or it may be placed next to a cupboard or a wall. Consider the clearance required to fully open the door in order to allow pulling out the drawers and shelves (see installation diagram).

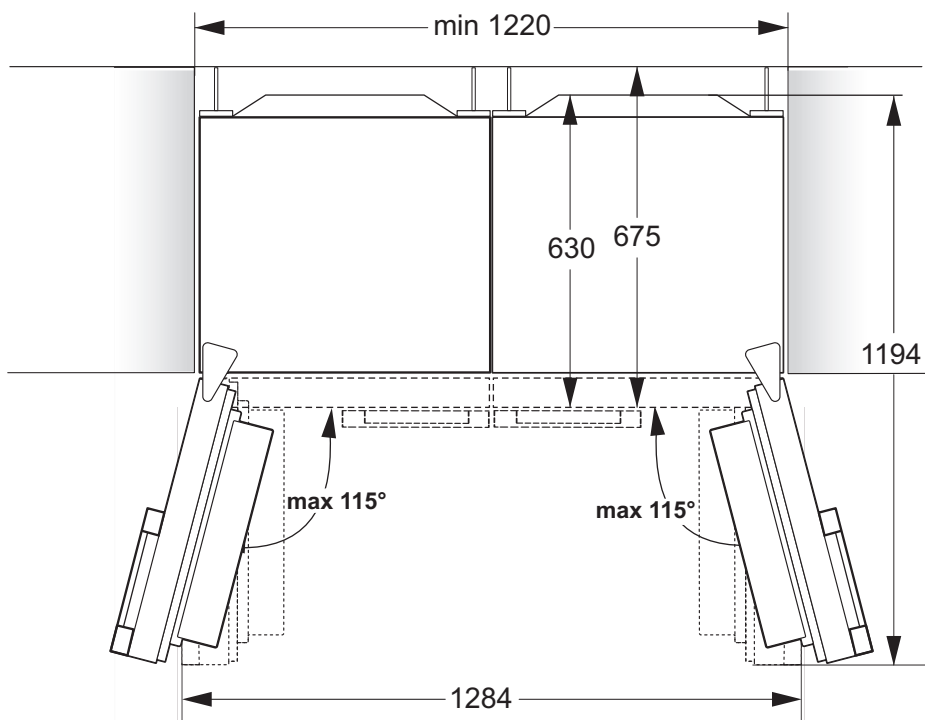

## INTRODUCTION

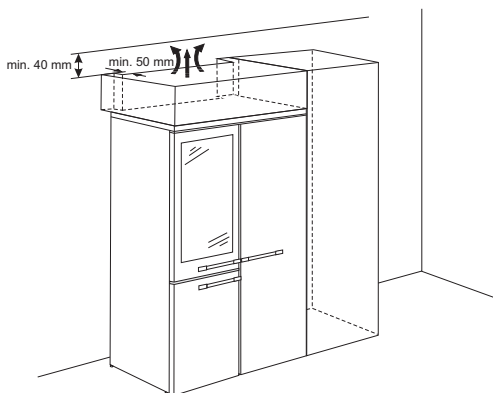
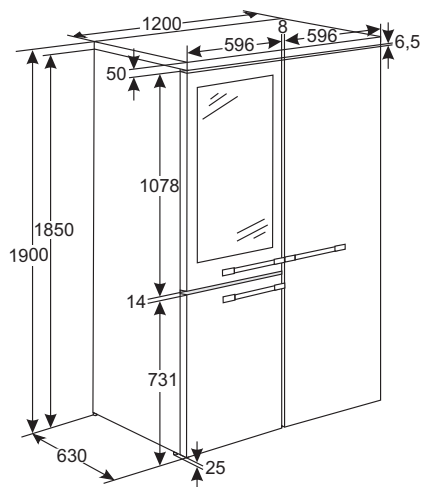

**Side-by-side installation:** We recommend leaving the side-by-side installation of two appliances to a service technician. If you decide to do this yourself, observe the instructions supplied with the side-by-side installation kit.

# INTRODUCTION

## Connecting the appliance

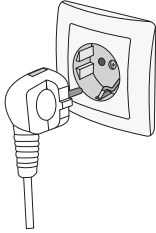

- Connect the appliance to the power mains using the power cord. The wall outlet should be fitted with a ground contact (safety socket). Nominal voltage and frequency are indicated on the rating plate/label with basic information of the appliance.
- The appliance must be connected to the power mains and grounded in compliance with the effective standards and regulations. The appliance will withstand short-term deviations from the nominal voltage, but not more than  $\pm 6\%$ .

## Changing the door opening direction

Tools required: socket wrench No. 8, Phillips screwdriver, torx 25, Hex key No. 4 and flat screwdriver.

The procedure to change the door opening direction opening should be carried out by at least two persons.

1. Remove the upper hinge cover (A) and the covering cap (G).
2. Undo the upper hinge (B) and remove the door (C) from the lower hinge (D).
3. Tilt the appliance backwards (make sure you do not press against the condenser unit on the rear wall of the appliance as this may damage the cooling system), unscrew the lower hinge (D) and the foot (E), and move them to the opposite side. Make sure the washer is installed like it was before disassembly.
4. Move the door hinges (F) to the opposite side, remove the door stopper S1 and attach the door stopper S2 supplied in a bag with the instruction manual. Place the door (C) back on the lower hinge (D).
5. Use the screws to attach the upper hinge (B) on the opposite side.
6. Install the upper hinge cover (A) and the covering cap (G).
7. Place the handle (L): undo the side screws (M) and the (N) screw in the handle holder. Take care not to damage the door. Pull the handle in the direction of the arrow. Disassemble the handle (L): undo the screw (O), turn the handle holder (P) by 180° and reattach it using the screw. On the opposite side of the door, remove the cover plugs (R) and place the handle (L) in the direction of the arrow 2. Reattach the handle using the screws (M) and (N). Place the covering plugs/caps (R) on the opposite side of the door.



# INTRODUCTION

1

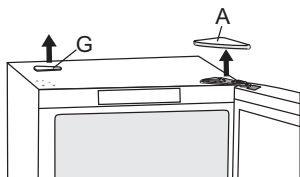

2

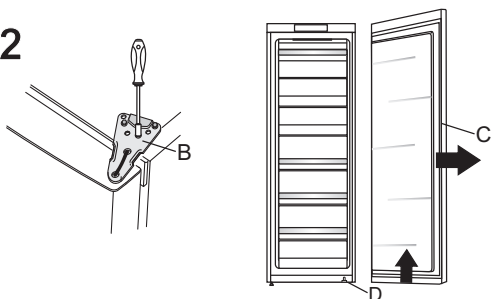

3

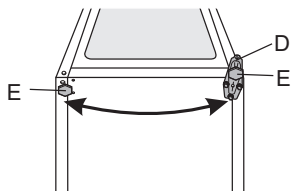

4

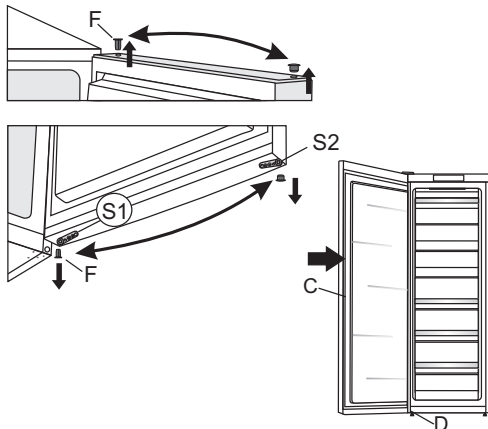

5

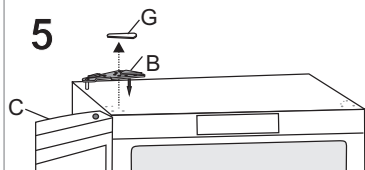

6

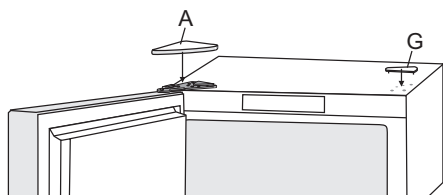

7

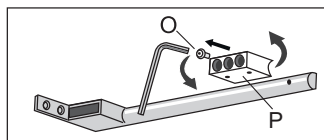
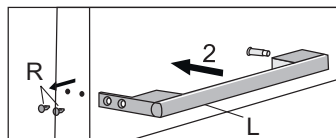
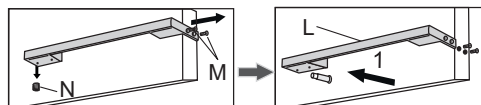

## APPLIANCE DESCRIPTION

### Appliance description

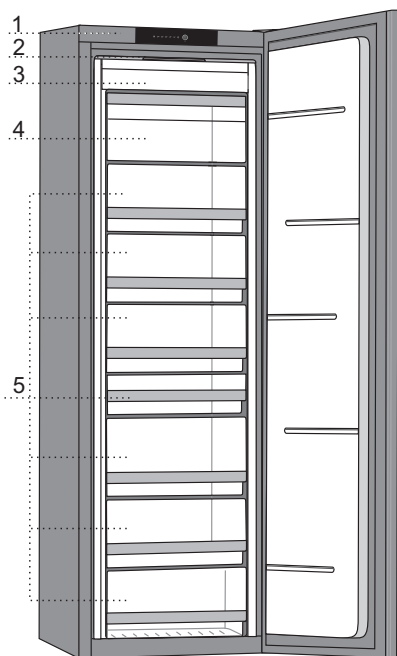

1. Control unit
2. LED lighting
3. NO FROST freezing unit
4. Storage compartment
5. Drawers for freezing and storage

## APPLIANCE DESCRIPTION

### Operating the appliance

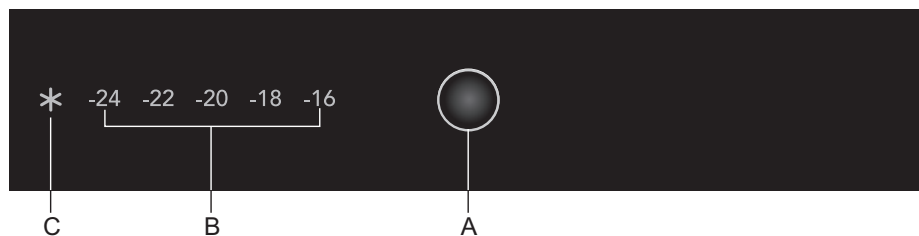

- A Temperature settings and extra function key
- B Temperature display  
The indicator for the selected temperature will be lit.
- C Intensive freezing (boost) function indicator  
Symbol **C** will be lit when the intensive freezing function is activated.

### Switching the appliance on/off

To **switch on** the appliance, plug the power cord into the power mains outlet.

To **switch off** the appliance, unplug the power cord from the power mains outlet.

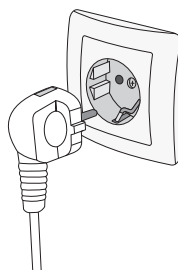

## APPLIANCE DESCRIPTION

### Adjusting the temperature in the appliance

- Adjust the temperature as desired using the **A** key.
- Press the **A** key (several times) until the desired temperature indicator lights up.
- The numbers -24, -22, -20, -18 and -16 indicate the degrees Celsius ( $^{\circ}\text{C}$ ) in the appliance.

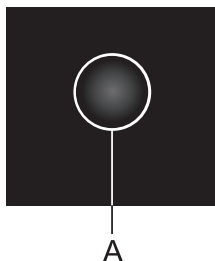

- The recommended temperature setting is  $-18^{\circ}\text{C}$ .
- If the ambient temperature is below  $16^{\circ}\text{C}$ , we recommend setting the temperature to  $-18^{\circ}\text{C}$  or lower.

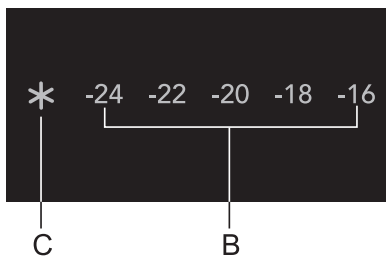

- After the appliance is switched on, it may take several hours for the set temperature to be reached. Do not place any food into the appliance before the temperature has dropped to the selected setting.

## APPLIANCE DESCRIPTION

### Intensive freezing (boost) function

To activate the intensive freezing (boost) function, press the **A** key several times until symbol **C** lights up.

- Use this setting after switching on the appliance for the first time, before cleaning, or 24 hours before adding a large amount of food.
- To switch off the intensive freezing function, press the **A** key to select the desired temperature (**B**). If the intensive freezing function is not deactivated manually, it will be automatically switched off (after approximately two days), and the temperature will return to the most recently set value.



- When the boost function is activated, the appliance will operate with maximum power. During this time, operation may be somewhat louder.

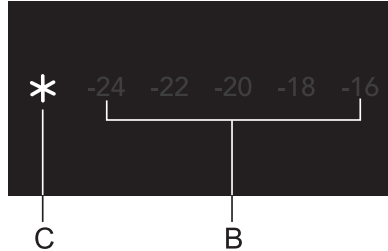

## APPLIANCE DESCRIPTION

### Appliance interior equipment

- The **MultiBox** is convenient for storing food with a strong or pungent smell.
- If the tray is used as an ice tray, fill it with water and place it in the freezer in a horizontal position.

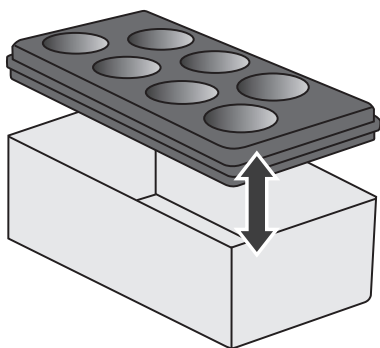

### *Freezing fresh food and storing frozen food*

#### **Freezing procedure**



Maximum amount of fresh food that may be inserted at once is specified on the appliance rating plate. If the amount of food to be frozen exceeds the indicated amount, the quality of freezing will be inferior; in addition, the quality of the food already frozen will deteriorate.

- To make use of the entire freezer volume, remove all drawers. Place the food directly on the shelves and on the freezer bottom.
- Activate the intensive freezing function 24 hours before freezing fresh food. Then, insert the fresh food into the freezer compartment.
- Make sure the fresh food is not in contact with the food that is already frozen.
- The most suitable place for freezing a large amount of fresh food is the upper section of the freezer.
- When freezing smaller amounts of food (1-2 kilograms), activating the intensive freezing function is not required.
- After 24 hours, the food can be moved to other freezer compartments and the freezing process can be repeated as necessary.

### Important warnings on freezing



- Only use the freezer to freeze food appropriate for freezing. Always use quality and fresh food.
- Select the most suitable packaging for the food and use the packaging correctly.
- Make sure the packaging is air and water tight so that the food does not dry out and lose its vitamins.
- Indicate the type of food, amount, and date of freezing on the packaging.
- It is important that the food freezes quickly. Therefore, smaller packages are recommended. Refrigerate the food before freezing.

### Storing industrially frozen food

- When storing and using frozen food, observe the manufacturer's instructions. Temperature and expiry date are indicated on the packaging.
- Only choose food with undamaged packaging, stored in freezers at temperatures of  $-18^{\circ}\text{C}$  or lower.
- Do not purchase food covered in frost as this indicates it has been partly thawed several times and that it is of inferior quality.
- Protect the food from thawing during transport. In case of an increase in temperature, storage time will be shorter and quality will deteriorate.



# STORING AND FREEZING FOOD

## Frozen food storage time

Recommended storage time in the freezer

Type of food	Time
fruit, beef	from 10 to 12 months
vegetables, veal, poultry	from 8 to 10 months
venison	from 6 to 8 months
pork	from 4 to 6 months
finely chopped or ground meat	4 months
bread, pastry, cooked meals, lean fish	3 months
entrails	2 months
smoked sausage, fatty fish	1 month

## Defrosting frozen food

Freezing the food does not kill the microorganisms. After the food is defrosted or thawed, bacteria are re-activated and the food spoils quickly. Use the partially or completely defrosted food as soon as possible.

Partial thawing decreases the nutritive value of the food, particularly fruit, vegetables, and ready-to-eat food.

### *Defrosting the appliance*

#### **Defrosting a No Frost freezer**

- The No Frost freezer will defrost automatically. Occasional frost that may appear on the walls will disappear automatically.
- Build-up of ice or frost in the freezer compartment can be a result of abnormal use of the appliance (door opened too frequently and/or too long, door not properly closed etc.). In this case, unplug the appliance, remove the food from the freezer and protect it from defrosting. Clean and dry the freezer interior. Before returning the frozen food into the freezer, switch on the appliance and select the desired setting.

## DEFROSTING AND CLEANING THE APPLIANCE

### Cleaning the appliance



Before cleaning, unplug the appliance from the power mains – switch off the appliance (see chapter 'Operating the appliance') and unplug the power cord from the wall outlet.

- Use a soft cloth to clean all surfaces. Cleaners that contain abrasive substances, acids, or solvents are not suitable for cleaning as they may damage the surface.
- Clean the appliance exterior with water or a mild solution of suds.
- Lacquer-coated and aluminium surfaces may be cleaned with lukewarm water to which you have added a mild detergent. Use of cleaners with low alcohol content is allowed (e.g. window cleaners). Do not use cleaners containing alcohol for cleaning plastic materials.
- Appliance interior can be cleaned with lukewarm water to which you can add some vinegar.
- Do not wash the parts of the appliance interior equipment in a dishwasher as they may be damaged.

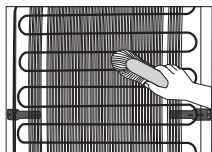

- The condenser unit mounted on the (exterior) back wall should always be kept clean, free of dust or deposits resulting from kitchen smoke or fumes. Occasionally clean the dust using a soft non-metal brush or a vacuum cleaner.
- After cleaning, switch the appliance back on and insert the food.

## Troubleshooting

Problem	Cause or remedy:
Appliance is connected to the power mains but it does not work.	<ul style="list-style-type: none"> <li>• Make sure there is voltage in the power outlet and that the appliance is switched on.</li> </ul>
Cooling system operates continuously for a long period of time:	<ul style="list-style-type: none"> <li>• Too high ambient temperature.</li> <li>• Door opened too frequently or too long.</li> <li>• Door not closed correctly (possible impurities on the seal, misaligned door, damaged seal etc.).</li> <li>• Too much fresh food inserted at once.</li> <li>• Insufficient compressor and condenser unit cooling. Check for sufficient air circulation behind the appliance and clean the condenser unit.</li> </ul>
Build-up of ice or frost in the freezer interior may be a result of the following:	<ul style="list-style-type: none"> <li>• Door opened too frequently or too long.</li> <li>• Door not properly closed.</li> <li>• Poor door sealing.</li> <li>• If the seal is dirty or damaged, clean or replace it.</li> </ul>
Door is difficult to open:	<ul style="list-style-type: none"> <li>• If you are trying to open the freezer door after just having closed it, this could be difficult to do. As you open the door, some cool air escapes from the appliance and it is replaced by warm air from the environment. When this air is cooled, negative pressure is generated which results in problems as you try to open the door. After a few minutes, the condition is normalized and the door can be easily opened again.</li> </ul>
LED lighting does not work:	<ul style="list-style-type: none"> <li>• If LED lighting does not work, call a service technician.</li> <li>• Do not attempt a repair of the LED lighting yourself, as there is danger of contact with high voltage!</li> </ul>

If the above tips do not resolve your problem, call the nearest authorized service centre and state the type, model, and serial number indicated on the appliance rating plate or label located in the appliance interior.

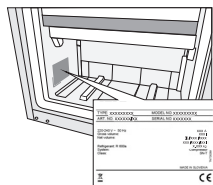

The rating plate can be found in the appliance interior (see figure).

### *Information about appliance noise*

Cooling in freezers is made possible by a cooling system that also includes a compressor (and a fan with some appliances), which generates some noise. The level of noise depends on installation, proper use, and age of the appliance.

- After connecting the appliance to the power mains, compressor operation, or the sound of flowing liquid, may be somewhat louder. This is not a sign of malfunction and it will not affect the useful life of the appliance. In time, appliance operation and this noise will become quieter.
- Sometimes, unusual or loud noises may appear during appliance operation; these are mostly the result of improper installation:
  - The appliance must stand level and stable on a solid base.
  - The appliance may not be in contact with a wall or adjacent furniture.
  - Make sure the interior equipment sits firmly in its place and that the noise is not caused by rattling cans, bottles or other containers placed next to each other.
- Due to the higher workload on the cooling system when the door is opened more frequently or for a longer time, when a large amount of fresh food is placed inside or when the intensive freezing function is activated, the appliance can temporarily generate more noise.

WE RESERVE THE RIGHT TO CHANGES THAT DO NOT AFFECT THE APPLIANCE  
FUNCTIONALITY.







The appliance identification card is located on the bottom of the appliance.

Stick the appliance identification card here.

When contacting the service department, have the complete type number to hand.

You will find the addresses and phone numbers of the service organisation on the warranty card.

